

Panel Light I-595x595

Datasheet



Features :

- High Brightness SMD LED
- Low Power Requirement & Energy Efficient
- Suitable for Restricted Space
- 2nd Lens Inside
- Color Consistency (3-Step Macadam ellipse)

Typical Applications :

- Office Lighting
- Shop Lighting

Specification :

- Color (3,000K/ 4,000K/ 5,700K)

Table of Contents

General Information.....	3
Product Dimension.....	3
Light Pattern.....	3
Product Information.....	4
Technical Data	4
Applications	5
Package Information	6
Revision History	7

General Information

Introduction

Utilizing Edison-Opto advanced PLCC LEDs, panel light is typically used in interior applications. Edison Opto provides a better lighting solution of light in office lighting and shop lighting applications.

The appearance of Edison opto panel light is elegant design with good uniformity to decoration, also it saves more energy and has lower light depreciation rates to decrease both energy and maintenance cost.

Without complicated installation and too much limited condition, Edison Opto panel light provides a great lighting solution for interior lighting applications.

Product Dimension

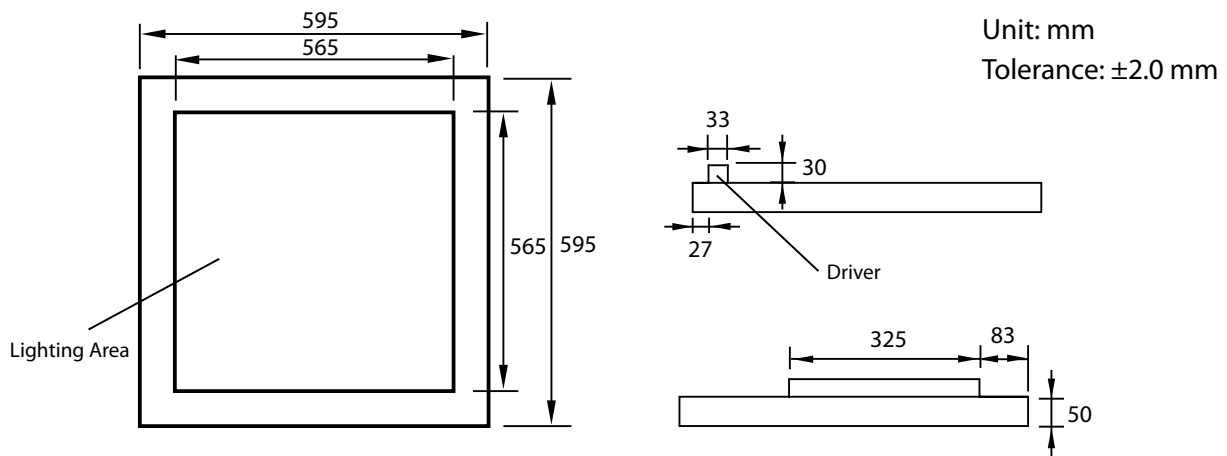

Light Pattern

• Beam Angle 115°

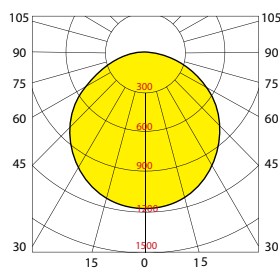

Product Information

Product Type				Product Order Code			
45W Panel Light I-595x595				7-PNLT-02			
Product Specification							
WATT		COLOR		ANGLE		DRIVER	
Code	Type	Code	Type	Code	Type	Code	Type
45	45W	57	CW (5700K)	F	> 70	A	100V~240V
		40	NW (4000K)				
		30	WW (3000K)				

Technical Data

Parameter	Symbol	Rating / Value	Units
Power Consumption	--	45	W
Power Factor	--	> 0.9	--
AC Input Voltage	V _F	100~240	V
Color Temperature	--	CW- 5700 NW- 4000 WW- 3000	K
CRI	--	> 80	--
Storage Temperature	T _{stg}	-20 ~ +60	°C
Operating Temperature	T _{opr}	-20 ~ +40	°C
Weight	--	< 4.5	kg

Notes:

1. Power Consumption has 10% tolerance.
2. The operating temperature* is based on the ambient temperature to the heatsink in 5 cm distance.

Power Consumption (W)	Beam Angle	Color	Flux(lm)
45W	115°	Cool White	3700
		Neutral White	3550
		Warm White	3350

Notes:

1. Flux is measured with an accuracy of ± 10%.
2. Brightness is measured by EDISON Integrating Sphere.

Applications

Panel light can produce an good uniformity light in a space. It can be easily installed or replaced a traditional lighting in office, shop, home and large outlet etc.



Package Information

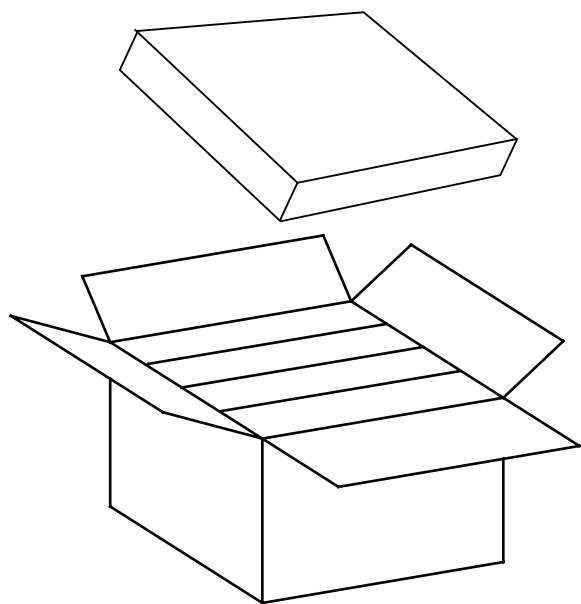

Notes:

1. Carton Size: 720mmX460mmX690mm
2. There are 4 pcs in a Carton
3. Weight: 19.1kg / Carton

Revision History

Versions	Description	Release Date
1	Update Product Dimension	2014/04/01

About Edison Opto

Edison Opto is a leading manufacturer of high power LED and a solution provider experienced in LDMS. LDMS is an integrated program derived from the four essential technologies in LED lighting applications- Thermal Management, Electrical Scheme, Mechanical Refinement, Optical Optimization, to provide customer with various LED components and modules. More Information about the company and our products can be found at www.edison-opto.com

Copyright©2014 Edison Opto. All rights reserved. No part of publication may be reproduced or transmitted in any form or by any means, electronic or mechanical, including photo copy, recording or any other information storage and retrieval system, without prior permission in writing from the publisher. The information in this publication are subject to change without notice.

www.edison-opto.com

For general assistance please contact:
service@edison-opto.com.tw

For technical assistance please contact:
LED.Detective@edison-opto.com.tw